



Job Name: _____

Submitted by: _____ Date: _____

Spec Section: _____

Job Location: _____

Engineer/Architect: _____

Approval: _____ Date: _____

Angle Pattern

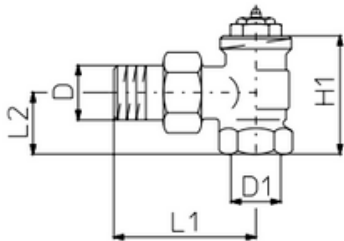

Straight Pattern

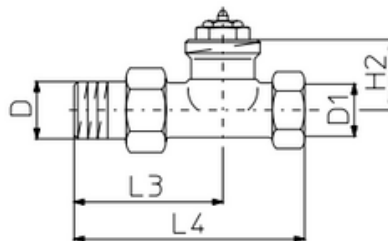

Reversed Angle Pattern

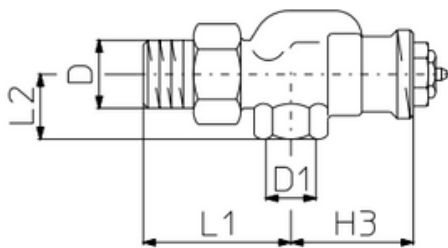

Product specification:

Oventrop thermostatic radiator valve "Series S"
Max. working temperature: 252°F
Max. working pressure: 145 psi
Low pressure steam 30 psia, 252°F.
Max. differential pressure: 14.5 psi
Body nickel plated, stem made of stainless steel with double O-ring seal.

Thermostat connection thread M 30 x 1.5

Complete valve insert replaceable under working conditions by using the special tool "Demo-Bloc."

These valves can be used with the following types of actuators:

1. Manual adjuster
2. Thermostatic (non-electric)
3. 24 V electric for on/off control

Size	NPT		L1	L2	L3	L4	H1	H2	H3
	D	D1							
1/2"	0.5	0.5	2.28	1.02	2.32	3.74	1.97	1.12	1.57
3/4"	0.75	0.75	2.60	1.14	2.48	4.17	2.09	1.12	1.46
1"	1.0	1.0	2.95	1.34	3.15	4.92	2.39	1.18	-
1 1/4"	1.25	1.25	3.39	1.54	3.54	5.91	2.68	1.31	-

Sizes and Types:

Angle pattern valve	NPT/NPT
1/2"	189 90 04
3/4"	189 90 06
1"	189 90 08
1 1/4"	189 90 10

Straight pattern valve	NPT/NPT
1/2"	189 91 04
3/4"	189 91 06
1"	189 91 08
1 1/4"	189 91 10

Reversed angle pattern valve	NPT/NPT
1/2"	189 92 04
3/4"	189 92 06

Insert:

The valve insert has a stainless steel seat and a metal-to-metal seal.

Stainless steel insert 118 62 00

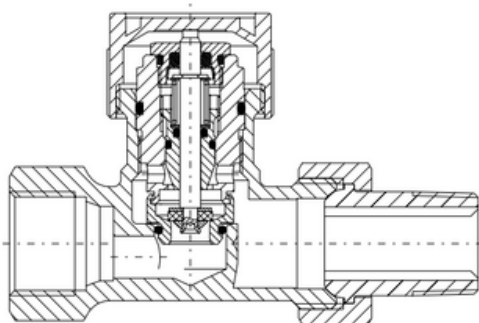

Straight pattern valve cross section shown with "AZ" EPDM insert