

Job Name: _____

Submitted by: _____ Date: _____

Spec Section: _____

Job Location: _____

Engineer/Architect: _____

Approval: _____ Date: _____

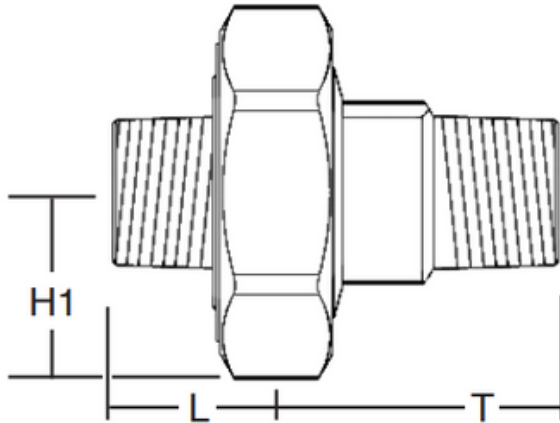

Specification

"Series 804" union adapter for connection from balancing valve to control valve.

Maximum working temperature: 250°F
Maximum working pressure: 600 psi / CWP

Coil Kit Dimensions in Inches

Union Sizes and Dimensions							
Dimensions		Union Body Size					
		1/2"	3/4"	1"	1 1/4"	1 1/2"	2"
H1		0.87	1.11	1.11	1.49	1.49	1.8
L	MNPT	1.00	1.00	1.14	1.40	1.45	1.56
	FNPT	0.83	0.83	-	-	-	-
1/2" Union Connection	MNPT	1.5	1.5	1.5	-	-	-
	SWT	0.83	0.87	-	-	-	-
	FNPT	-	0.83	-	-	-	-
3/4" Union Connection	MNPT	-	1.56	1.56	1.8	1.8	-
	SWT	-	0.98	0.98	-	-	-
	FNPT	-	-	-	-	-	-
1" Union Connection	MNPT	-	-	1.75	1.8	1.8	2.51
	SWT	-	-	1.0	-	-	-
	FNPT	-	-	-	1.0	-	-
1 1/4" Union Connection	MNPT	-	-	-	1.8	1.8	1.98
	SWT	-	-	-	1.43	-	-
	FNPT	-	-	-	-	1.75	-
1 1/2" Union Connection	MNPT	-	-	-	-	1.8	1.98
	SWT	-	-	-	-	1.17	-
	FNPT	-	-	-	-	-	1.8
2" Union Connection	MNPT	-	-	-	-	-	1.98
	SWT	-	-	-	-	-	1.5
	FNPT	-	-	-	-	-	-



Size	Item Number
1/2"	804 1 _ _ _ _
3/4"	804 2 _ _ _ _
1"	804 3 _ _ _ _
1 1/4"	804 4 _ _ _ _
1 1/2"	804 5 _ _ _ _
2"	804 6 _ _ _ _

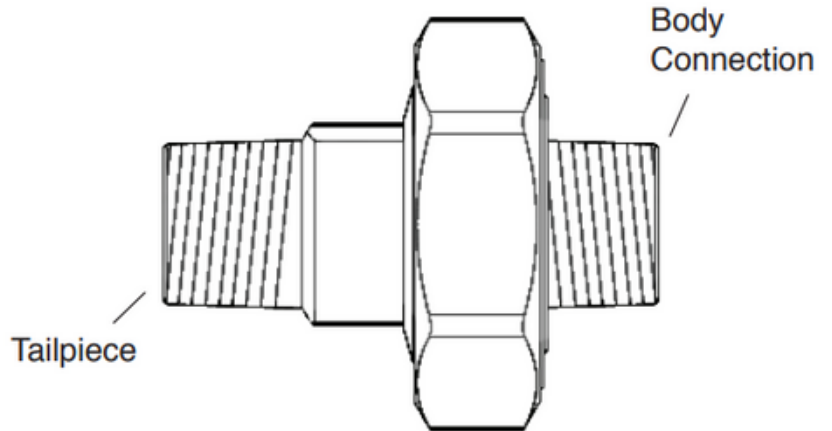

Example valve selection:
1 1/4" SWT valve with 3/4" MNPT tailpiece
Item number - 804 4223

for SWT body valves			
Item	Item	Connection	Item
4213	4213	1/2" MNPT	52
4223	4223	3/4" MNPT	52
4233	4233	1" MNPT	52
4241	4241	1 1/4" FNPT	52
4242	4242	1 1/2" FNPT	52
4243	4243	2" FNPT	52

Isolator body and tailpiece designations for FNPT body valves

1/2" Body Tailpieces		3/4" Body Tailpieces		1" Body Tailpieces		1 1/4" Body Tailpieces		1 1/2" Body Tailpieces		2" Body Tailpieces	
Item	Connection	Item	Connection	Item	Connection	Item	Connection	Item	Connection	Item	Connection
1111	1/2" FNPT	2111	1/2" FNPT	3113	1/2" MNPT			5123	3/4" MNPT	6133	1" MNPT
1112	1/2" SWT	2112	1/2" SWT	3122	3/4" SWT	4123	3/4" MNPT	5133	1" MNPT	6143	1 1/4" MNPT
1113	1/2" MNPT	2113	1/2" MNPT	3123	3/4" MNPT	4133	1" MNPT	5143	1 1/4" MNPT	6153	1 1/2" MNPT
		2121	3/4" FNPT	3131	1" FNPT	4141	1 1/4" FNPT	5151	1 1/2" FNPT	6161	2" FNPT
		2122	3/4" SWT	3132	1" SWT	4142	1 1/4" SWT	5152	1 1/2" SWT	6162	2" SWT
		2123	3/4" MNPT	3133	1" MNPT	4143	1 1/4" MNPT	5153	1 1/2" MNPT	6163	2" MNPT